



MADE IN THE USA

**KEYSCO TOOLS
DIVISION OF S&H INDUSTRIES**

5200 Richmond Road • Cleveland, OH 44146
 Phone 216-831-0550 • Toll Free 800-253-9726 •
 Fax 216-831-9573
 www.shindustries.com
 E-Mail: www.service@shindustries.com
 Rev. 9/23/16

ECONOMY FENDER STAND – 77786

The Keysco Tools Economy Fender Stand provides secure holding of one or two fenders for prep and finish work. Adjustable arms move to provide a secure hold of fender ends. Folds for easy storage.

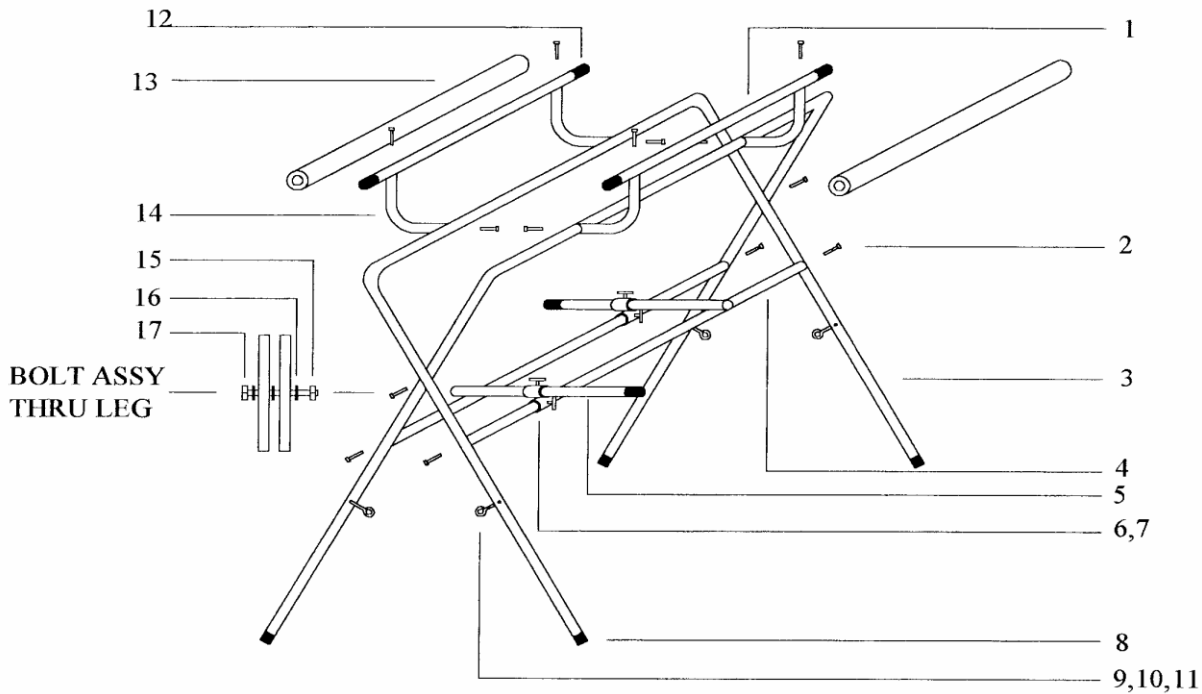

| Key # | Part # | Description | Qty. | Key # | Part # | Description | Qty. |
|-------|--------|---------------------|------|-------|--------|----------------------|------|
| 1 | 11678 | Top rail | 2 | 10 | 10201 | 1/4-20 Hex nut | 8 |
| 2 | 10675 | 1/4-20 x 2" bolt | 12 | 11 | 11529 | Chain | 2 |
| 3 | 11673 | Leg | 2 | 12 | 10688 | Tubing cap | 4 |
| 4 | 11677 | Slider support tube | 2 | 13 | 10762 | Protective cover | 2 |
| 5 | 11679 | Pusher tube | 2 | 14 | 11674 | Rail support | 4 |
| 6 | 11676 | Slider assembly | 2 | 15 | 10178 | 1/4-20 Lock nut | 2 |
| 7 | 11379 | Knob | 4 | 16 | 10218 | 1/4" USS washer | 6 |
| 8 | 10673 | Rubber tip | 6 | 17 | 10766 | 1/4-20 x 2-1/2" Bolt | 2 |
| 9 | 11530 | Eyebolt | 4 | | | | |

*During assembly make sure the mounting holes in the legs for #14 are positioned so the holes are facing outward away from each other and not upwards/vertical. When #14 is attached to the leg assembly the rail supports should then face upwards to accept the top rail. If the mounting holes for #14 do not align properly please flip the legs around until the proper position is achieved. Please note the rail supports will not be a perfect 90 degree angle, as the legs are moved into different positions the degree of the rail supports will change.